

### Introduction

The following sports data sheets are for use in conjunction with Sport England's 'Developing the Right Sports Hall' (DRSH) main document. They relate to Step 5 'Establishing the Project Brief' and identify the needs of the priority sport and the key secondary sports.

These sheets show the requirements for Netball as the 'Priority Sport' at various levels of play and other 'Secondary Sports' that can fit into the same overall space.

New Level of Play Category <sup>1</sup>	Level of Play			
	International	Premier	Club	Community
	This category relates to the lowest level of International play <sup>2</sup>	This category relates a Premier / National League Club competing in regional or Inter county competitions	This category relates to a local club competing in District and County League competitions	This category relates to school and community use where there is no formal competitive structure / no specific need for space for officials or spectator accommodation
<b>Netball equivalent</b> <sup>3</sup>	International and Super League	Regional and Premier League	Local club and inter county competition	School and recreational use

### Commentary

The sports data sheets use the NGB's requirements for the field of play. The additional space requirements for officials are indicated separately as 'optional' for club and recreational levels of play. Spectators zones for match play are not included and are assumed to be a site specific requirement. For further details of the requirements for netball see the *Facilities and Court Information* available from England Netball's (EN) website: [http://www.englandnetball.co.uk/the-game/Facilities\\_and\\_Courts](http://www.englandnetball.co.uk/the-game/Facilities_and_Courts) and the 'Indoor Netball Facility Requirements' for International levels of play (Development section) from the *International Federation of Netball Associations* (IFNA) website <http://www.netball.org>. For further details of the requirements for 'secondary sports', see *Appendix 8* of the main DRSH document for links to other NGB's websites.

<sup>1</sup> New level of play categories for each sport as agreed by the NGBs and Sport England and applicable throughout this document.

<sup>2</sup> For higher levels of international competition, such as major championships, the relevant NGB should be consulted at a very early stage as the requirements vary considerably.

<sup>3</sup> For other sports, see Appendix 4 'Level of play categories for each sport' within main document.



### Key Issues

- **Spatial requirements:** Netball practice can be played on all courts that are 30.5 x 15.25 m. When there is insufficient space for a full size court and full size run offs, then there should be a risk assessment to allow reduced run offs with the court being retained at 30.5 x 15.25 m.
- **Court markings:** For International and Premier levels of play, line markings to be white. For multi sport halls, where other line markings conflict, other colours can be used except yellow.
- **Walls / Ceilings:** Walls to be a dark colour and ceilings to be a light colour.
- **Flooring:** Goal posts to be secured in floor sockets complying with EN requirements. Floor fixings are only acceptable for retrofitting. Flooring to be area elastic category. End and side run-offs shall have the same surface as the playing area and be free of all permanent and temporary fixtures at court level and to a vertical height of 2.5m.
- **Lighting:** Uniformity ratio = Emin / eav. It is recommended that the system also allows lighting at 200 lux for training etc.
- **Spectator Provision:** There should be early consultation with England Netball on the spectator requirements for each project as these will vary from club to club and site to site.

**Note:** For further details see England Netball and IFNA websites and Sport England's design guidance notes 'Sports Halls Design and Layouts', 'Floors for Indoor Sports' and 'Artificial Sports Lighting'.

## Primary Sport

<b>Netball - Overview</b>		Source of information:		<a href="http://www.englandnetball.co.uk/the-game/Facilities_and_Courts">http://www.englandnetball.co.uk/the-game/Facilities_and_Courts</a> and <a href="http://www.netball.org">http://www.netball.org</a> <a href="http://www.sportengland.org/facilities_planning/design_and_cost_guidance.aspx">http://www.sportengland.org/facilities_planning/design_and_cost_guidance.aspx</a>									
International and Super League	Premier	Overall space (m) incl. R/O + T/O											
		Principal playing area (m)			Run offs (m)			Additional areas (m)		Specification			
		L x W x H	Length	Width	Height	Ends	Sides	Between courts / Between courts with a dividing net	T/O	SS	Flooring	Lighting	
		<b>International</b>	<b>36.60</b> <b>23.35</b> <b>8.30</b> + TV zone	30.50	15.25	8.30	3.05	3.05	4.00 / 6.10	2.00 + additional perimeter zone for TV cameras	500 - 10000 seats	Any meeting IFNA standards	1500 lux 0.7 Emin / eav
		<b>Club</b>	<b>36.60</b> <b>23.35</b> <b>7.50</b>	30.50	15.25	7.50	3.05	3.05	4.00 / 6.10	2.00	Optional	Any meeting AENA standards	750 lux 0.7 Emin / eav
		<b>Community</b>	<b>34.50</b> <b>18.25</b> <b>7.50</b>	30.50	15.25	7.50	2.00	1.50	3.00 / 3.00	Optional	Optional	Any meeting AENA standards	750 lux 0.7 Emin / eav
		<b>Premier</b>	<b>36.60</b> <b>23.35</b> <b>7.50</b>	30.50	15.25	7.50	3.05	3.05	4.00 / 6.10	2.00	Optional	Any meeting AENA standards	750 lux 0.7 Emin / eav
		<b>Club</b>	<b>36.60</b> <b>21.35</b> <b>7.50</b>	30.50	15.25	7.50	3.05	3.05	4.00 / 6.10	Optional	Optional	Any meeting AENA standards	750 lux 0.7 Emin / eav
		<b>Community</b>	<b>34.50</b> <b>18.25</b> <b>7.50</b>	30.50	15.25	7.50	2.00	1.50	3.00 / 3.00	Optional	Optional	Any meeting AENA standards	750 lux 0.7 Emin / eav

## Primary Sport

<b>Netball</b>				Source of information: <a href="http://www.englandnetball.co.uk/the-game/Facilities_and_Courts">http://www.englandnetball.co.uk/the-game/Facilities_and_Courts</a> and <a href="http://www.netball.org">http://www.netball.org</a> <a href="http://www.sportengland.org/facilities_planning/design_and_cost_guidance.aspx">http://www.sportengland.org/facilities_planning/design_and_cost_guidance.aspx</a>							
<b>International and Super League</b>				<b>Overall space (m) incl. R/O + T/O</b> <b>36.60 x 23.35 x 8.30 + additional perimeter zone for TV cameras</b>							
	<b>Principal playing area (m)</b>			<b>Run offs (m)</b>		<b>Additional areas (m)</b>		<b>Specification</b>			
				<b>R/O</b>							
	<b>L x W x H</b>	Length	Width	Height	Ends	Sides	Between courts / Between courts with a dividing net	Space for teams (T) and match officials (O)	Spectator seating	Flooring	Lighting
<b>36.60 x 23.35 x 8.30 + TV zone*</b>	30.50	15.25	8.30	3.05	3.05	4.00 / 6.10	2.00	500 - 10000 seats	Any meeting IFNA standards	1500 lux 0.7 Emin / eav	

## Secondary Sports

\* Perimeter zone for TV cameras varies on a site by site basis and dimensions have not been included (nominal allowance assumed for secondary sports court layouts)

Sport	Number	Compliance	Level										
Badminton	4 court format	✓	Club	<b>33.00</b> <b>17.40</b> <b>7.50</b>	13.40	6.10	7.50	2.00	1.50	1.50 / 2.60	Optional	Optional	Combined, area or mixed elastics Lower (500 lux)
Basketball	1 court format	✓	Premier	<b>32.10</b> <b>20.10</b> <b>7.00</b>	28.00	15.00	7.00	2.05	2.05	4.10 / 4.10	1.00	Required	Semi-sprung wooden or synthetic Lower (500 lux)
Indoor Cricket	5 lanes	✓	Club / Community	<b>33.62</b> <b>23.70</b> <b>7.70</b>	31.62	3.66	7.70	1.00	1.00	3.40 for basket - ball goal	-	-	Mats req/d (to ECB standards) Lower (750 lux)
Volleyball	0 court format (lengthways)	✗	-	-	<b>Volleyball disallowed</b> - see 'Facility and Court Information' section from England Netball website for International and Super League courts: 'Note 6. Tennis post sockets and other equipment fixtures shall not be located within the playing area, side run offs or end run offs of the Netball court.'								
Volleyball Training	0 court format (transverse)	✗	-	-									
Basketball Training	Rings on side walls	✓	Training	-									

## Primary Sport / Secondary Sport Issues

## Netball - International and Super League (cont/d)

### Notes of key issues for international netball

- See 'Key Issues' on page 1 cover sheet.
- Hatched areas indicate space which is excess to secondary sport requirements. In some cases, this can provide improved circulation and space for spectators and wheelchair users.
- International levels of play for Netball have been based on the IFVA's requirements but including only a single court (in lieu of twin courts) in conjunction with an additional practice area close to the competition court. (not incorporated within this exercise). An additional perimeter zone for TV cameras is required and an indicative zone has been shown - however the extent of this zone varies on a site-by-site basis and dimensions

have not been included. Therefore, only the court area, run-offs and officials areas have been included in the overall dimensions. The IFNA height requirements also exceed those for England Netball dedicated facilities.

- An England Netball accredited test laboratory shall survey and test the facility to ensure compliance with Category 5 Court Requirements within two months of construction and after any resurfacing works. The facility operator shall be responsible for commissioning the survey. Following the survey the laboratory will prepare a detailed report and copies will be sent to the facility operator and England Netball.
- To cater for young people's Netball (High Five Netball) and

Wheelchair Netball, goal posts shall have adjustable net ring heights of 3.05 m, and 2.44 m.

- Tennis post sockets and other equipment fixtures shall not be located within the playing area, side run offs or end run offs of the Netball court.
- If space is limited, a common team bench area 1.5 m wide between adjacent courts may be provided i.e. a total of 4.5 m between courts.
- Line markings to be white.
- IFNA have further requirements for International events - visit <http://www.netball.org>

## Secondary Sports

Layouts for other sports within a dedicated international netball space of 36.60 x 23.35 x 8.30 m + additional perimeter zone for TV cameras

### Badminton (Club)

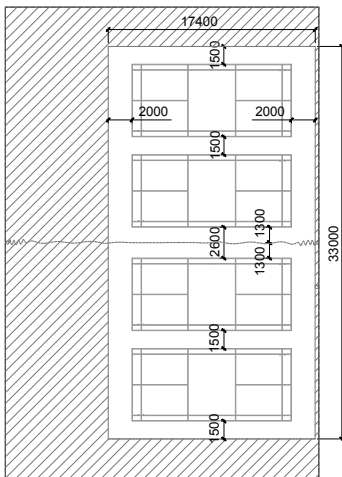

### Basketball (Premier)

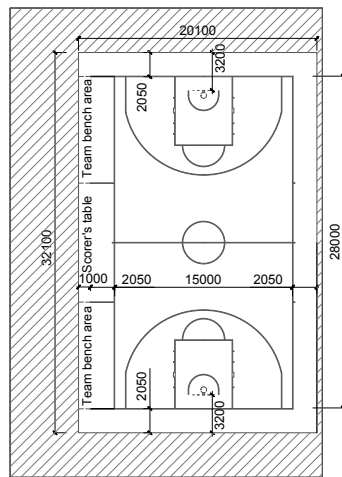

### Indoor Cricket

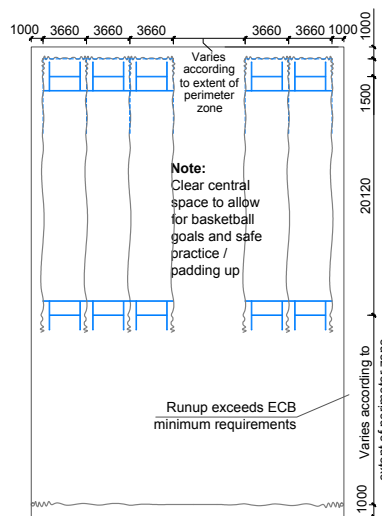

### Volleyball (Premier)

### Volleyball Training (transverse)

- cannot be accommodated in an international netball space

**Volleyball disallowed** - see 'Facility and Court Information' section from England Netball website for International and Super League courts: 'Note 6. Tennis post sockets and other equipment fixtures shall not be located within the playing area, side run offs or end run offs of the Netball court.'

### Basketball Training

- can be accommodated in an International netball space  
- number and location to project specific requirements

## Primary Sport

<b>Netball</b>				Source of information:		<a href="http://www.englandnetball.co.uk/the-game/Facilities_and_Courts">http://www.englandnetball.co.uk/the-game/Facilities_and_Courts</a> <a href="http://www.sportengland.org/facilities_planning/design_and_cost_guidance.aspx">http://www.sportengland.org/facilities_planning/design_and_cost_guidance.aspx</a>											
<b>Premier</b>				<b>Overall space (m) incl. R/O + T/O</b> <b>36.60 x 23.35 x 7.50</b>													
				<b>Principal playing area (m)</b>			<b>Run offs (m)</b>			<b>Additional areas (m)</b>		<b>Specification</b>					
				L x W x H	Length	Width	Height	R/O			T/O	SS	Flooring	Lighting			
								Ends	Sides	Between courts / Between courts with a dividing net	Space for teams (T) and match officials (O)	Spectator seating					
				36.60	30.50	15.25	7.50	3.05	3.05	4.00 / 6.10	2.00	Optional	Any meeting AENA standards	750 lux 0.7 Emin / eav			
<b>Secondary Sports</b>																	
Sport	Number	Compliance	Level	L x W x H	Length	Width	Height	Ends	Sides	Between courts / Between courts with a dividing net	T/O	SS	Flooring	Lighting			
Badminton	4 court format (including 1 dividing net)	✓	Club	33.00 17.40 7.50	13.40	6.10	7.50	2.00	1.50	1.50 / 2.60	Optional	Optional	Combined, area or mixed elastics	Lower (500 lux)			
Basketball	1 court format	✓	Premier	32.10 20.10 7.00	28.00	15.00	7.00	2.05	2.05	4.10 / 4.10	1.00	Optional	Semi-sprung wooden or synthetic	Lower (500 lux)			
Indoor Cricket	4 lanes	✓	Club / Community (Except height)	33.62 20.04 7.70	31.62	3.66	7.70	1.00	1.00	3.40 for basket - ball goal	-	-	Mats req/d (to ECB standards)	Same (750 lux)			
Volleyball	1 court format (lengthways)	✓ (See overleaf)	Premier	28.00 17.00 7.50	18.00	9.00	7.50	5.00	3.00	6.00 / 6.00	2.00	-	Area elastic	Lower (500 lux)			
Volleyball Training	2 court format (transverse)	✓ (See overleaf)	Training	30.00 20.00 7.50	18.00	9.00	7.50	1.00	3.00	6.00 / 6.00	N/A	N/A	Area elastic	Lower (500 lux)			
Basketball Training	Rings on side walls	✓	Training														

## Primary Sport / Secondary Sport Issues

### Netball - Premier (cont/d)

#### Notes of key issues for premier netball

- See 'Key Issues' on page 1 cover sheet.
- Hatched areas indicate space which is excess to secondary sport requirements. In some cases, this can provide improved circulation and space for spectators and wheelchair users.
- Premier Netball requires a warm-up netball court. However, it is not mandatory that this warm-up hall requires being close to the competition court (as in for International level of play and as set out in the AENA regulation requirements) and can be located remotely from the main competition hall. Therefore, a single court hall has been included for this level of play.
- An England Netball accredited test laboratory shall survey and test the facility to ensure compliance with Category 5 Court Requirements within two months of construction and after any resurfacing works (see Notes on page 1 cover sheet).
- To cater for young people's Netball (High Five Netball) and Wheelchair Netball, goal posts shall have adjustable net ring heights of 3.05 m, and 2.44 m.
- Values shall be measured on the playing surface. Measurements shall be made on a 5 m grid over the court area.
- The facility operator shall be responsible for commissioning the survey. Following the survey the laboratory will prepare a detailed report and copies will be sent to the facility operator and England Netball.
- Tennis and other post sockets shall not be located within the playing area, side run offs or end run offs of the Netball court. However some sports equipment, such as volleyball net posts safely secured using appropriate base plates with weights / floor fixings, may be incorporated subject to approval with England Netball / NGB.
- Line markings to be white.
- AENA have further requirements for Premier (National) events - see <http://www.englishnetball.co.uk>

## Secondary Sports

Layouts for other sports within a dedicated premier netball space of 36.60 x 23.35 x 7.50 m

### Badminton (Club)

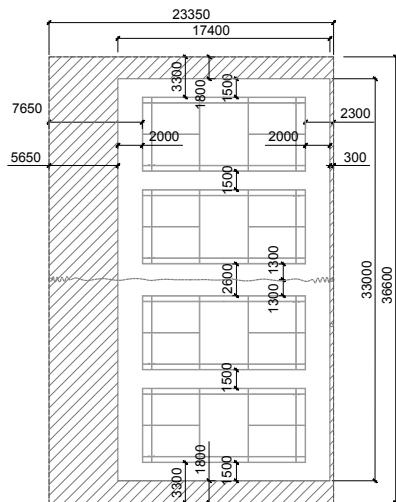

### Basketball (Premier)

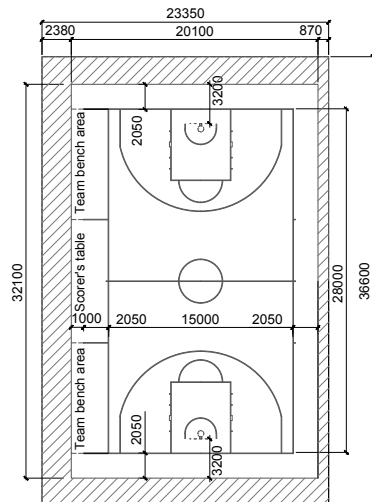

### Indoor Cricket

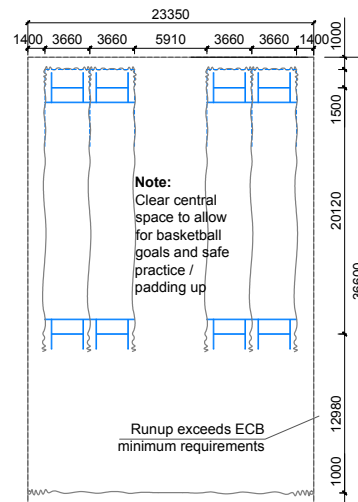

### Volleyball (Premier)

(See conditions above)

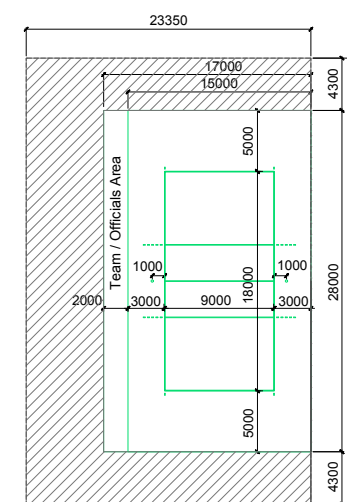

### Volleyball/Basketball Training (transverse)

(See conditions above)

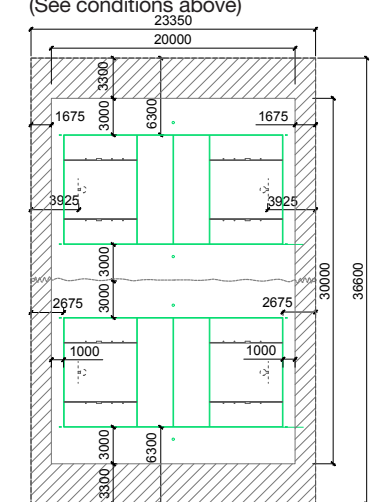



## Primary Sport

<b>Netball</b>				Source of information:		<a href="http://www.EnglandNetball.co.uk/the-game/Facilities_and_Courts">http://www.EnglandNetball.co.uk/the-game/Facilities_and_Courts</a> <a href="http://www.sportengland.org/facilities_planning/design_and_cost_guidance.aspx">http://www.sportengland.org/facilities_planning/design_and_cost_guidance.aspx</a>										
Club				Overall space (m) incl. R/O <b>36.60 x 21.35 x 7.50</b>												
				Principal playing area (m)			Run offs (m)			Additional areas (m)		Specification				
				R/O			T/O		SS							
				L x	W x	H	Length	Width	Height	Ends	Sides	Between courts / Between courts with a dividing net	Space for teams (T) and match officials (O)	Spectator seating	Flooring	Lighting
				<b>36.60</b>	<b>21.35</b>	<b>7.50</b>	30.50	15.25	7.50	3.05	3.05	4.00 / 6.10	Optional	Optional	Any meeting AENA standards	750 lux 0.7 Emin / eav
<b>Secondary Sports</b>																
Sport	Number	Compliance	Level													
Badminton	4 court format	✓	Club	<b>31.90</b>	<b>17.40</b>	<b>7.50</b>	13.40	6.10	7.50	2.00	1.50	1.50 / 2.60	-	-	Combined, area or mixed elastics	Lower (500 lux)
Basketball	1 court format	✓	Club	<b>32.10</b>	<b>20.10</b>	<b>7.00</b>	28.00	15.00	7.00	2.05	2.05	4.10 / 4.10	1.00	Optional	Semi-sprung wooden or synthetic	Lower (500 lux)
Indoor Cricket	3 lanes	✓ (Except height)	Club / Community	<b>33.62</b>	<b>20.04</b>	<b>7.70</b>	31.62	3.66	7.70	1.00	1.00	3.40 for basket - ball goal	-	-	Mats req/d (to ECB standards)	Same (750 lux)
Volleyball	1 court format (lengthways)	✓	Premier	<b>28.00</b>	<b>17.00</b>	<b>7.50</b>	18.00	9.00	7.50	5.00	3.00	6.00 / 6.00	2.00	-	Area elastic	Lower (500 lux)
Volleyball Training	2 court format (transverse)	✓	Training	<b>30.00</b>	<b>20.00</b>	<b>7.50</b>	18.00	9.00	7.50	1.00	3.00	6.00 / 6.00	N/A	N/A	Area elastic	Lower (500 lux)
Basketball Training	Rings on side walls	✓	Training	-												

## Primary Sport / Secondary Sport Issues

### Netball - Club (cont/d)

#### Notes of key issues for club netball

- See 'Key Issues' on page 1 cover sheet.
- Hatched areas indicate space which is excess to secondary sport requirements. In some cases, this can provide improved circulation and space for spectators and wheelchair users.
- An England Netball accredited test laboratory shall survey and test the facility to ensure compliance with Category 3 Court Requirements within two months of construction and after any resurfacing works.
- End run-offs and side run-offs shall have the same surface as the playing area. They shall be free of all permanent and temporary fixtures at court level and to a vertical height of 2.5 m.
- To cater for young people's Netball (High Five Netball) and Wheelchair Netball, goal posts shall have adjustable net ring heights of 3.05 m, 2.75 m and 2.44 m. The values shall be measured on the playing surface. Measurements shall be made on a 5 m grid over the court area.
- The safety margins indicated between the cricket practice nets and walls are higher (indicative dimensions indicated) than the minimum required to allow for the basketball training courts with retractable goals fitted to the side walls - see the ECB TS3 document for further advice on recommended clearances.
- Basketball practice rings can be related to the volleyball training court (see diagram below for Volleyball / Basketball training) or placed independently without any specific court markings.

## Secondary Sports

Layouts for other sports within a club netball space of 36.60 x 21.35 x 7.50 m

### Badminton (Club)

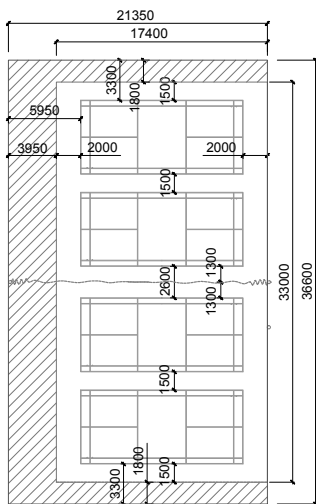

### Basketball (Club)

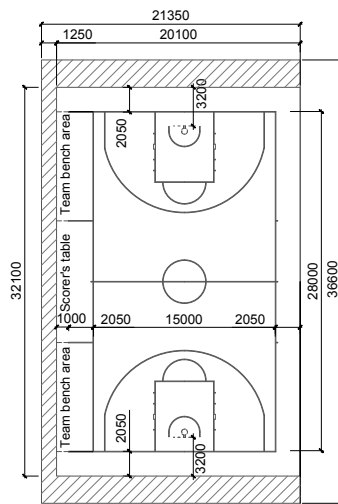

### Indoor Cricket

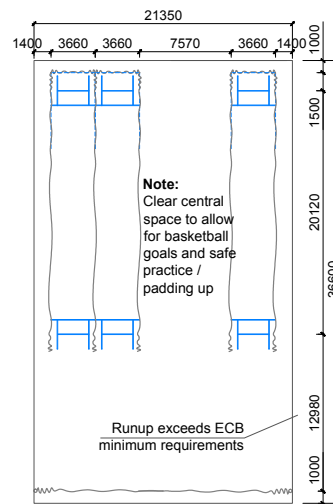

### Volleyball (Premier)

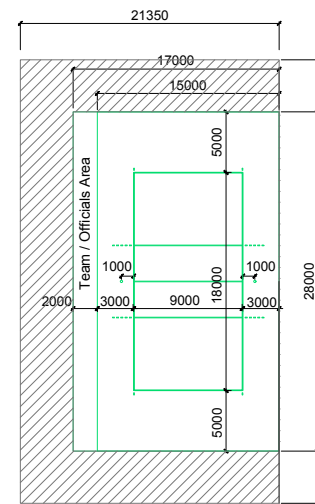

### Volleyball/Basketball Training (transverse)

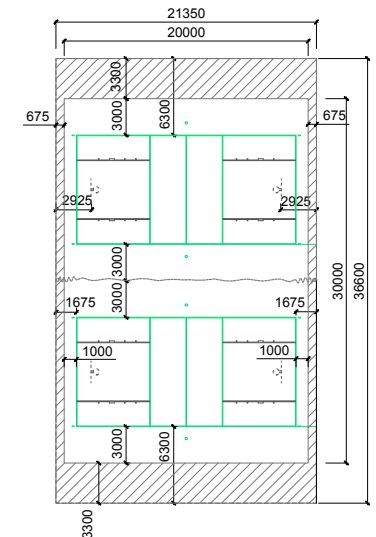



## Primary Sport

<b>Netball</b>				Source of information:		<a href="http://www.EnglandNetball.co.uk/the-game/Facilities_and_Courts">http://www.EnglandNetball.co.uk/the-game/Facilities_and_Courts</a> <a href="http://www.sportengland.org/facilities_planning/design_and_cost_guidance.aspx">http://www.sportengland.org/facilities_planning/design_and_cost_guidance.aspx</a>											
<b>Community</b>				<b>Overall space (m) incl. R/O + T/O</b> <b>34.50 x 18.25 x 7.50</b>													
				<b>Principal playing area (m)</b>			<b>Run offs (m)</b>			<b>Additional areas (m)</b>		<b>Specification</b>					
							<b>R/O</b>			<b>T/O SS</b>							
				<b>L x W x H</b>	Length	Width	Height	Ends	Sides	Between courts / Between courts with a dividing net	Space for teams (T) and match officials (O)	Spectator seating	Flooring	Lighting			
				<b>34.50</b>	30.50	15.25	7.50	2.00	1.50	3.00 / 3.00	Optional	Optional	Any meeting AENA standards	750 lux 0.7 Emin / eav			
<b>Secondary Sports</b>																	
Sport	Number	Compliance	Level														
Badminton	4 court format	✓	Club	<b>31.90</b> <b>17.40</b> <b>7.50</b>	13.40	6.10	7.50	2.00	1.50	1.50 / 2.60	-	-	Combined, area or mixed elastics	Lower (500 lux)			
Basketball	0 court format	✗	Community	<b>32.10</b> <b>19.10</b> <b>7.00</b>	28.00	15.00	7.00	2.05	2.05	4.10 / 4.10	-	-	Semi-sprung wooden or synthetic	Lower (500 lux)			
Indoor Cricket	2 lanes	✓ (Except height)	Club / Community	<b>33.62</b> <b>12.72</b> <b>7.70</b>	31.62	3.66	7.70	1.00	1.00	3.40 for basket - ball goal	-	-	Mats req/d (to ECB standards)	Same (750 lux)			
Volleyball	1 court format (lengthways)	✓	Premier	<b>28.00</b> <b>17.00</b> <b>7.50</b>	18.00	9.00	7.50	5.00	3.00	6.00 / 6.00	2.00	-	Area elastic	Lower (500 lux)			
Volleyball Training	0 court format (transverse)	✗	Training	<b>20.00</b> <b>15.00</b> <b>7.50</b>	18.00	9.00	7.50	1.00	3.00	6.00 / 6.00	N/A	N/A	Area elastic	Lower (500 lux)			
Basketball Training	Rings on side walls	✓	Training	-													

## Primary Sport / Secondary Sport Issues

### Netball - Community (cont/d)

#### Notes of key issues for community netball

- See 'Key Issues' on page 1 cover sheet.
- Hatched areas indicate space which is excess to secondary sport requirements. In some cases, this can provide improved circulation and space for spectators and wheelchair users.
- The community netball court shown at 34.5 x 18.25 m with 2.0 m run off at ends and 1.5 m to the sides is the minimum size recommended by England Netball.
- For a community netball court located within a 34.5 x 20 m sports hall, the court should be offset to give a 1.75 m margin on one side with 1.5 m side run offs.
- End run-offs and side run offs shall have the same surface as the playing area. They shall be free of all permanent and temporary fixtures at court level and to a vertical height of 2.5 m.
- To cater for young people's Netball (High Five Netball) and Wheelchair Netball, goal posts shall have adjustable net ring heights of 3.05 m, 2.75 m and 2.44 m. The values shall be measured on the playing surface. Measurements shall be made on a 5 m grid over the court area.
- The minimum safety margins indicated between the cricket practice nets and walls should be increased if basketball training rings are fitted to the side walls - see the ECB TS3 document for further advice on recommended clearances.

## Secondary Sports

### Layouts for other sports within a community netball space of 34.50 x 18.25 x 7.50 m

#### Badminton (Club)

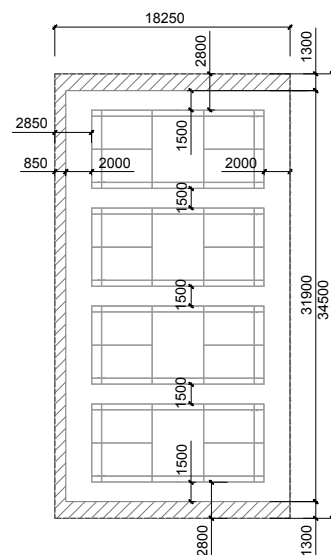

#### Basketball (Community)

- cannot be accommodated in a community netball space, unless it is made wider or if side margins are reduced subject to risk assessment

#### Indoor Cricket

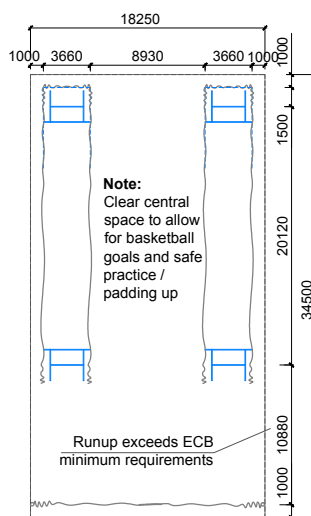

#### Volleyball (Premier)

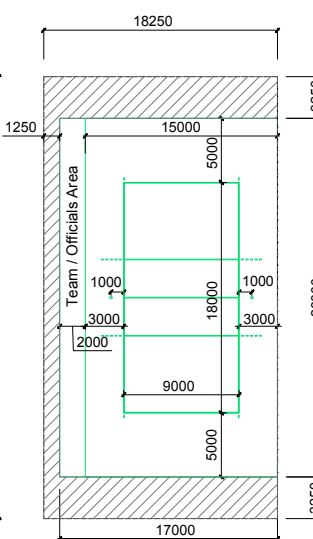

#### Volleyball Training (transverse)

- cannot be accommodated in a community netball space, unless it is made wider

#### Basketball Training

- can be accommodated in a community netball space  
- number and location to project specific requirements