

NOTE  
 WALL BARS ARE FLOOR AND WALL  
 FIXED, (SEE DRAWING  
 No WB-17 FOR DETAILS)

SECTION THRO' HORIZONTAL  
 RAIL  
 Parana pine  
 Scale 1:1

VERTICAL STILES AND COVER LATHS, SEE DRAWING WB-02 FOR DETAILS

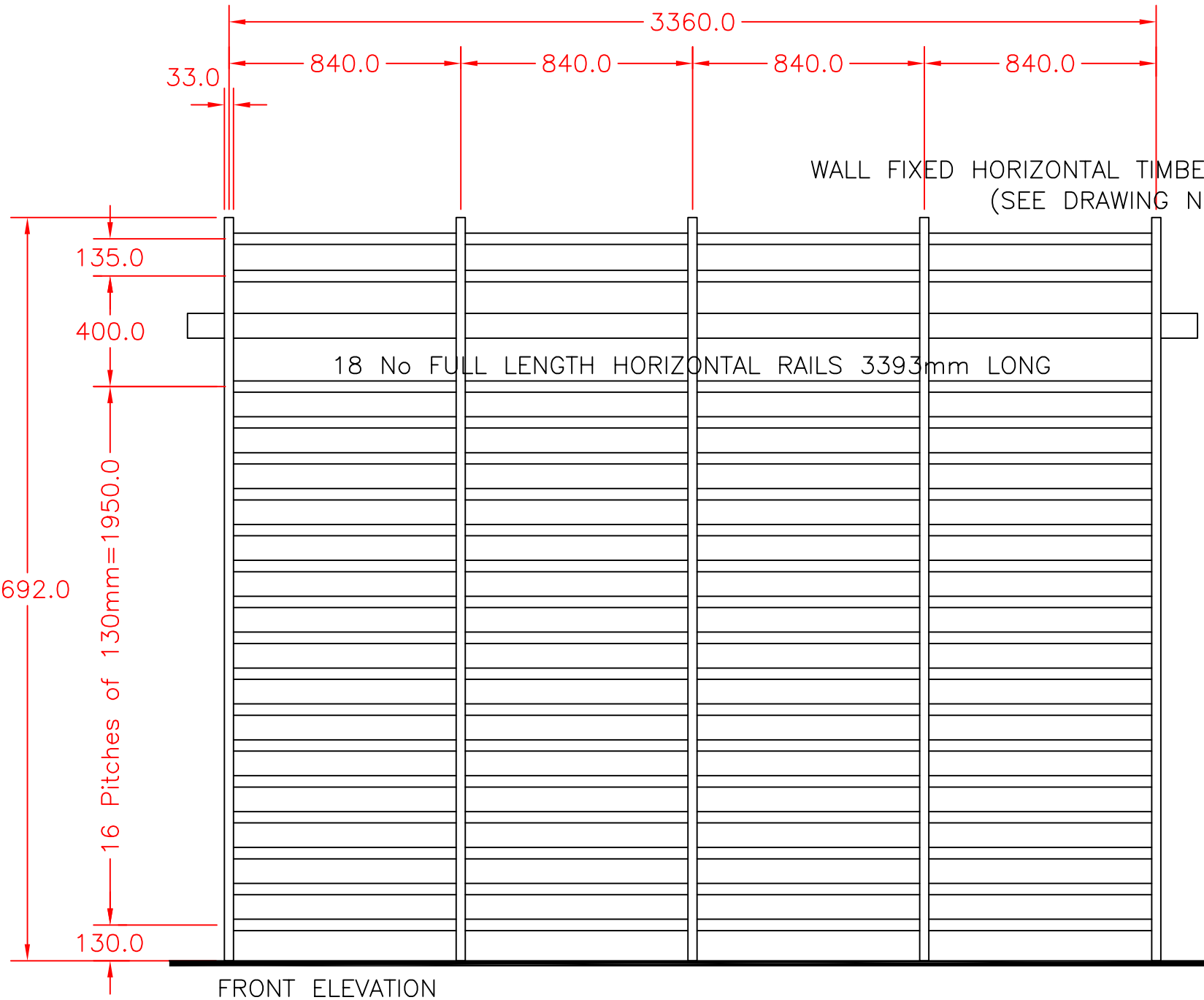

FRONT ELEVATION

THE WALL BARS ARE MADE TO B.S  
 1892 PART 1 1986.

WALL FIXED HORIZONTAL TIMBER BEARER  
 (SEE DRAWING No WB-16)

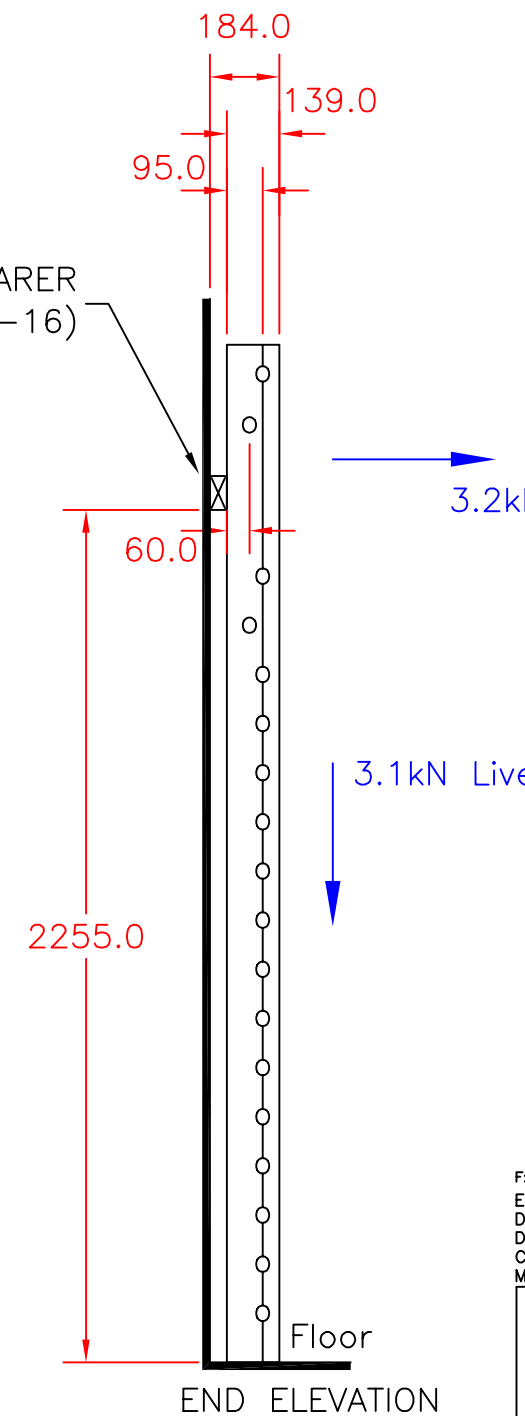

END ELEVATION

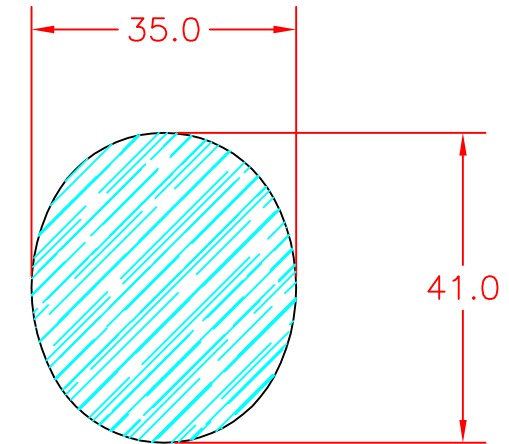

3.2kN Live

3.1kN Live

F: RC CSP2-2382 4/11/14. LOADING INFORMATION ADDED TO DRAWING.  
 E: TJH, 27/08/03, CSP2-1757. STILE AND COVER LATH  
 DRAWING REFERENCE INCORRECTLY REFERRED TO WB-01.  
 D: NGK CSP2 1624 29/08/02, MINOR UPDATED CHANGES.  
 C: TJH, 24/01/01, CSP2-1477. REDRAWN ON C.A.D. WITH  
 MINOR UPDATED CHANGES.



Tel:Huddersfield(01484)542051 Fax:(01484)539148

FOUR BAY – FIXED WALL BARS  
 GENERAL ARRANGEMENT

Tolerances as detailed on SPE001  
 unless noted on the dimension.  
 ALL DIMENSIONS ARE GIVEN IN  
 MILLIMETRES.  
 DO NOT SCALE OFF DRAWING.

scale	date	dr	rev
1:20	24/01/01	T.J.H.	F

dwg no  
**WB-13**